

SPIN s.r.l.

Via Casalecchio 35/G
47924 Rimini (RN) Italy
Tel. +39 0541.730777
Fax +39 0541.731315
e-mail: info@spinsrl.it
www.spinsrl.it

SPIN

ATF



ATF SPIN

Manual

automatic transmission cleaner and exchanger

Lavacambi Automatici Manuale

R MIN

Atf RÉMIN manual



ATF RÉMIN

COD. 02.023.55

IT

- **A:** Pannello comandi con manometro olio usato, rubinetti/commutatori di fase e flussimetri
- **B:** Kit raccordi e tubi per vetture europee e asiatiche (di serie)
- **C:** **SmartPack** (password per accesso gratuito per 12 mesi alla banca dati online)
- **D:** Iniettore additivo di 500ml con protezione contro manovre errate
- **E:** Inversione tubi manuale (integrato)
- **F:** Taniche olio nuovo/usato da 20 lt rimovibili
- **G:** Nuovo filtro sinterizzato con magneti (riusabile)
- **H:** Contaltri magnetici: Utili per il controllo visivo dei livelli (olio usato, olio nuovo)
- **I:** Uso facilitato dell'apparecchio

EN

- **A:** Control panel with used oil pressure gauge, taps/phase switches and flowmeters
- **B:** Kit of couplings and hoses for European and Asiatic vehicles (standard included)
- **C:** **SmartPack** (12 months of free access to the online Database)
- **D:** 500ml additive injector with protection against operational errors
- **E:** Manual hoses inversion (integrated)
- **G:** 20 liter removable oil containers for new/used oil
- **G:** New sintered magnetic filter (reusable)
- **H:** Magnetic litre-counters: Useful for visual control of the levels (used oil, new oil)
- **I:** Facilitated use of the appliance



ATF RÉMIN SPIN USER'S GUIDE

						ATF PUMP	CAR ENGINE
VERIFY THE PRESSURE PRESENCE ON THE GAUGE						OFF	ON
ADDITIVE INJECTION						ON	OFF
CLEANING						OFF	ON
EMPTY THE OIL PAN						OFF	ON
REMOVE THE OIL PAN						OFF	OFF
RADIATOR CLEANING						ON	OFF
FILTER CHANGE & OIL PAN REMOUNT						OFF	OFF
FILL THE PAN WITH NEW OIL						ON	OFF
OIL CHANGE IN THE TORQUE CONVERTER ADJUST SLOWLY THE TAP						ON	ON
RESTORE THE CONNECTION						OFF	OFF
OIL LEVEL CONTROL						ON	OFF
USED OIL DISCHARGE						ON	OFF

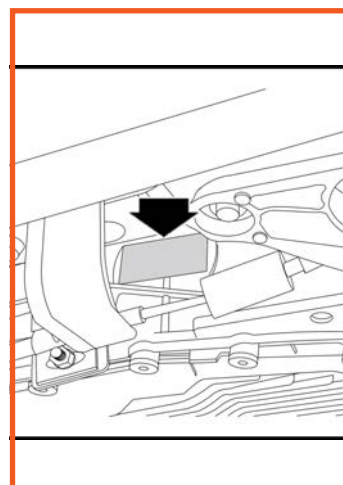
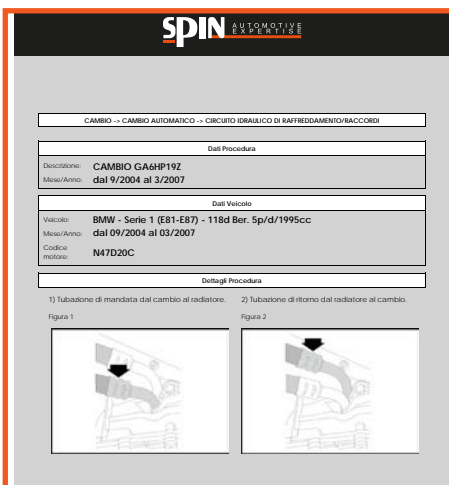
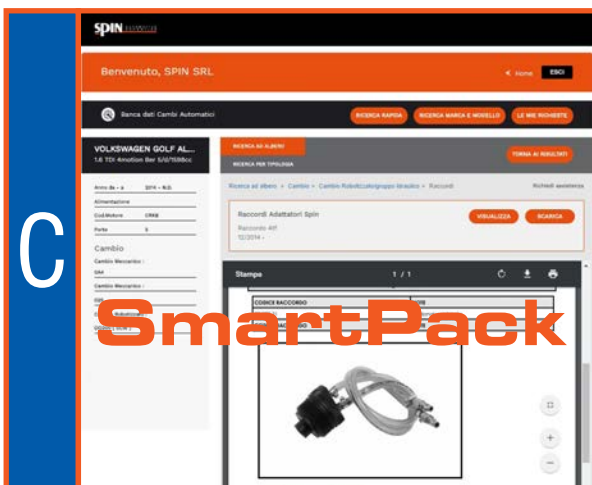
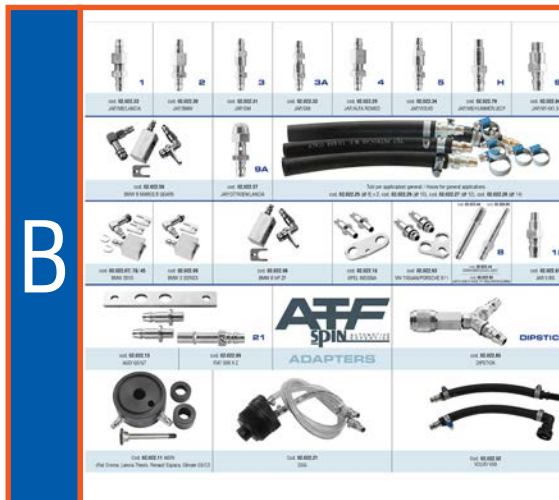
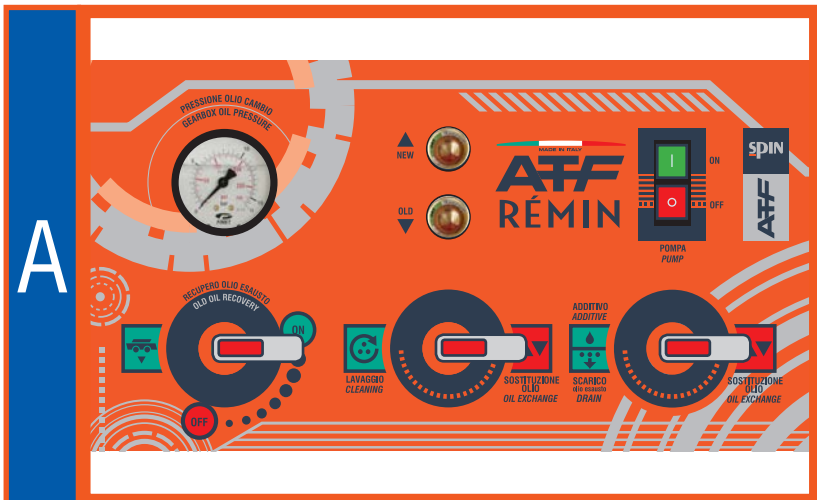

**RACCORDI STANDARD
STANDARD FITTINGS
RACCORDS STANDARD**

**RACORES ESTÁNDAR
STANDARD ADAPTERS
СТАНДАРТНЫЕ ФИТИНГИ**



<p>Cod. 02.022.11 AISIN (Fiat Croma, Lancia Thesis, Renault Espace, Citroen C5/C3)</p>		<p>Cod. 02.022.21 DSG</p>		<p>Cod. 02.022.52 VOLVO V50</p>	
<p>cod. 02.022.59 BMW 8 MARCE/8 GEARS</p>		<p>cod. 02.022.98 BMW 8 HP ZF</p>		<p>cod. 02.022.85 DIPSTICK</p>	
cod. 02.022.33 JAP/MB/LANCIA	cod. 02.022.30 JAP/BMW	cod. 02.022.31 JAP/GM	cod. 02.022.32 JAP/GM	cod. 02.022.29 JAP/ALFA ROMEO	cod. 02.022.34 JAP/VOLVO
cod. 02.022.79 JAP/MB/HUMMER/JEEP	cod. 02.022.84 JAP/M14X1,5	cod. 02.022.37 JAP/CITROEN/LANCIA	cod. 02.022.81 JAP/1/8G	cod. 02.022.44 BMW/MERCEDES 2001	cod. 02.022.80 JAP/RUBBER HOSE FITTING/POR-TAGOMMA
cod. 02.022.07/.78/.45 BMW 2010	cod. 02.022.09 BMW 3 SERIES	cod. 02.022.18 OPEL INSIGNA	cod. 02.022.63 VW TIGUAN/PORSCHE 911	cod. 02.022.13 AUDI Q5/Q7	cod. 02.022.99 FIAT 500 X ZF
Tubi per applicazioni generali / Hoses for general applications			Tubi per applicazioni generali / Hoses for general applications		
cod. 02.022.25 (ø 8) x 2		cod. 02.022.26 (ø 10)		cod. 02.022.27 (ø 12)	
				cod. 02.022.28 (ø 14)	

02.022.74		> Staffa speciale per Audi A8 > <i>Special adapter for Audi A8</i>		02.022.107		> Kit raccordi per Maserati > <i>Adapter kit for Maserati</i>	
02.022.62		> Blocchetto per Mercedes CLK > <i>Block for Mercedes Benz CLK</i>		02.022.100		> Raccordo scambiatore olio/ acqua cambio Toyota Avensis K311 da usare con tubi gomma Ø8 cassetta standard > <i>Coupling for oil/water exchanger Toyota Avensis K311 gearbox to be used with rubber hoses Ø8 from standard case</i>	
02.022.73		> Kit per Renault-Nissan < 2003, cambi DPO > <i>Kit for Renault - Nissan < 2003, transmissions DPO</i>		02.022.101		> Raccordo scambiatore aria/ olio cambio Toyota Corolla da usare con tubi gomma Ø8 cassetta standard > <i>Coupling for oil/water exchanger Toyota Corolla gearbox to be used with rubber hoses Ø8 from standard case</i>	
02.022.65		> Kit raccordi BMW 330D 180Hp > <i>Adapter kit for BMW 330D 180Hp</i>		02.022.102		> Raccordo scambiatore aria/ olio cambio Mazda CX-5 (6 AT) da usare con tubi gomma Ø8 cassetta standard > <i>Coupling for oil/water exchanger Mazda CX-5 (6 AT) gearbox to be used with rubber hoses Ø8 from standard case</i>	
02.022.88		> Kit per Porsche Cayenne / VW Touareg / Audi Q8 > <i>Kit for Porsche Cayenne / VW Touareg / Audi Q8</i>		02.022.104		> Raccordo scambiatore olio/ acqua cambio Nissan CVT (JF011E/REOF10A) > <i>Coupling for oil/water exchanger Nissan CVT (JF011E/REOF10A)</i>	
02.022.86		> Kit raccordi Volvo XC90 > <i>Adapter kit for Volvo XC90</i>		02.022.105		> Raccordo scambiatore olio/ acqua cambio Nissan 6CVT > <i>Coupling for oil/water exchanger Nissan 6CVT</i>	
02.022.61		> Kit adattatori per cambi Powershift (Volvo - Ford Focus) > <i>Adapter kit for Powershift gearbox (Volvo - Ford Focus)</i>		02.022.108		> Kit piastra per Citroen C4/C5 PICASSO > <i>Adapter kit for Citroen C4/C5 PICASSO</i>	
02.022.93		> Kit raccordi per Audi 4/6 Avant > 2012, cambio 4G5 su scambiatore > <i>Adapter kit for Audi 4/6 Avant > 2012 (4G5) on oil exchanger</i>		02.022.109		> Kit piastra Renault Espace per Nissan/Jeep/Mitsubishi > <i>Adapter kit for Renault/Jeep/Mitsubishi</i>	
02.022.94		> Kit adattatori per Mercedes Benz , cambio 722.9 > <i>Adapter kit for Mercedes Benz, 722.9 gearbox</i>		02.022.04		> Kit 2 aste livello olio Mercedes Classe A e C > <i>Kit 2 oil level dipstick Mercedes A-Class & C-Class</i>	
02.022.95		> Kit adattatori per TF80 MULTI gearboxes (Volvo, Alfa Romeo, Cadillac, Ford, Land Rover)		02.000.62		> Kit per vetture USA/Giappone > <i>Kit for USA/Japan vehicles</i> (Ford, Cadillac, Toyota, Nissan, Chrysler Jeep, GM, Dodge, Honda, Chevrolet, Chevy Duramax)	
02.022.72		> Kit adattatore Jatco per Nissan/Renault/Jeep/Mitsubishi > <i>Adapter kit Jatco for Nissan/ Renault/Jeep/Mitsubishi</i>					
02.022.97		> Kit adattatore Mercedes Classe A/B , cambio DCT > <i>Adapter kit for Mercedes-Benz A-Class & B-Class, DCT gearbox</i>					
02.022.66		> Rabboccatore livello olio > <i>Oil level refiller</i>					